

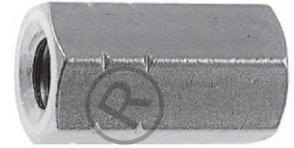

DIN 6334

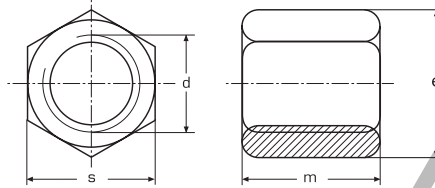

Nakrętka sześciokątna
wysoka 3d
A2 / A4



| d | m | e | s |  |
|------|----|------|----|---|
| M 5 | 15 | 9,0 | 8 | 100 |
| M 6 | 18 | 11,1 | 10 | 100 |
| M 8 | 24 | 15,0 | 13 | 100 |
| M 10 | 30 | 19,6 | 17 | 100 |
| M 12 | 36 | 21,9 | 19 | 50 |
| M 14 | 42 | 24,5 | 22 | 50 |
| M 16 | 48 | 27,7 | 24 | 50 |
| M 20 | 60 | 34,6 | 30 | 10 |
| M 24 | 72 | 41,6 | 36 | 10 |
| M 30 | 90 | 53,1 | 46 | 10 |