

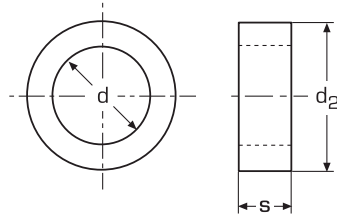

# DIN 7989



Podkładka pod śruby  
do konstrukcji stalowych  
**A2 / A4**

d	dla gwintu	d2	s	
11	M 10	21	8	50
14	M 12	24	8	50
18	M 16	30	8	50
22	M 20	37	8	50
24	M 22	39	8	50
26	M 24	44	8	25
30	M 27	50	8	25
33	M 30	56	8	10
36	M 33	60	8	10
39	M 36	66	8	10